

maxwell.eco

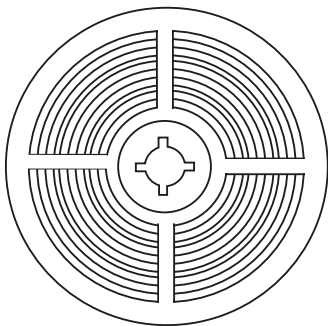

CINTA DE LUZ LED BLUETOOTH

Manual de Usuario

How to Connect?

Step1: Connect LED Controller with LED Light Strip.

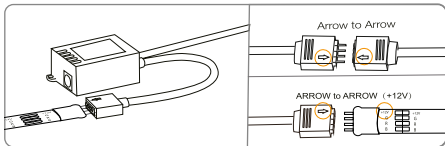

Step2: Connect the LED Controller with power supply.

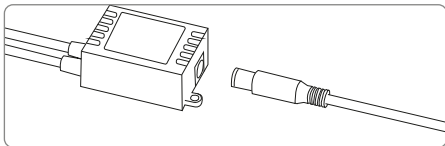

Step3: Plug in the power supply.

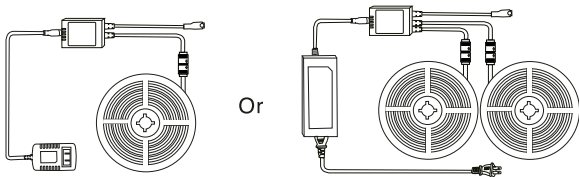

WARNING

- ⚠ Do not connect the power supply to wall plug before installation.
- ⚠ Spread out the lights strip before using.
- ⚠ Test the lights before installing.

How to Install?

1. Stick on the smooth, dry, clean surface.



2. Any rough and dusty surface can not be stuck.

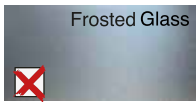

3. Clean the surface, dry out and stick it.

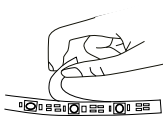

4. Press the whole strip lights repeatedly with force.

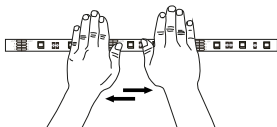

5. Pull out the transparent chip

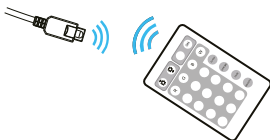
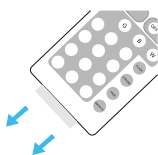

CONTROL METHODS

Control with IR Remote Controller

For controllers with infrared function to operate the lights.

24 KEY

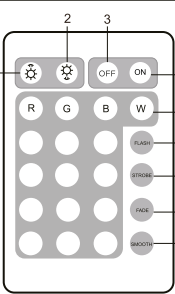

1.LED brightness adjustment button (up).	
2.LED brightness adjustment button (down).	
3.OFF button.	
4.ON button.	
5.LED color buttons (16 colors): Static red/ Static green/ Static blue/ Static white Static orange/ Static pea green/ Static dark blue Static dark yellow/ Static cyan/ Static brown Static yellow/ Static light blue/ Static pink Static straw yellow/ Static sky blue/ Static purple	
6,Flash button: Flash on and off.	
7,Strobe button: Fast change LED colors in every 3 seconds.	
8,Fade button: Fade out the current LED color and fade in to the next LED color in every 3 seconds.	
9,Smooth button: Fade out the current LED color and fade in to the next LED color in every 0.5 seconds.	

ATTENTION!

- 1.Supply voltage of this product is DC 12V never connect to DC 24V or AC 220V,only use the adapter come by our package.
- 2.If the power supply is damaged, do not attempt to repair it yourself. Please leave it to a professional technician to deal with.
- 3.Please avoid this product use in the humid environment.
- 4.To avoid any damage to the strip, please do not use chemical solvent during routine maintenance.
- 5.The angle of the IR receiver is 120° and the sensing distance is 8 meters. Please control within the sensing range.

Control with App on Your smartphone

1. Install the App on your Smartphone
2. Two ways own the APP download
 - 1) Enter the browser scan the QR code, choose Android or Google to download APP
 - 2) Download the APP via search "Apollo Lighting" or "Apollo Life with innovation"

Method 1: Download the APP via search "Apollo Lighting" or "Apollo Life with innovation"	Method 2: Scan the below QR code and switch to App Store /Google play store to download.
	

Bluetooth Connection

Step 1. Please enter your phone settings, open the Bluetooth.

Step 2. Open the "Apollo Lighting" app, The app will connect the LED light automatically.

Step 3. Touch the on/off key, start controlling the Bluetooth LED strip light.

If you can't connect with the Bluetooth LED strip light

1. Please disconnect the power cord and bluetooth receiver, then reconnect.
2. Please enter your phone setting and connect Bluetooth again.
3. Please close the APP, then try to restart.
4. Touch the on/off key.

MAIN USER INTERFACE

1. On/ Off: Click the bulb logo to turn on/ off the device
2. Adjust: Change the color and adjust bright.

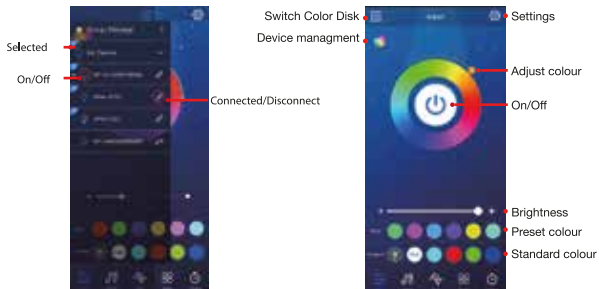

3. Music: Change the color by music rhythm.
4. Tape: Change the color by received voice rhythm of phone microphone.

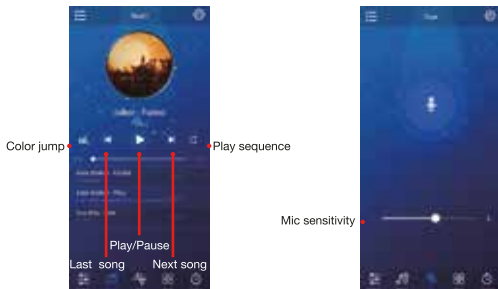

5. Style: Change the color by fixed style.

6. Timing: Timers setting.

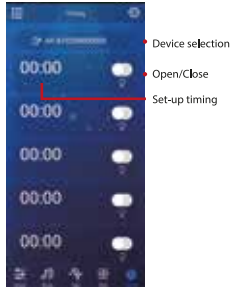
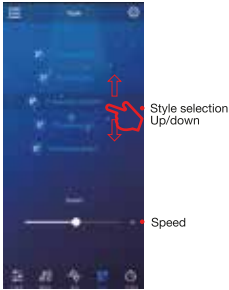

7. Timer setting: How to set the timer

8. Settings: Shake: Change the LED color by shaking the phone.

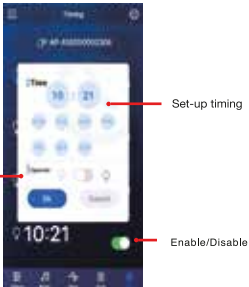

QUESTIONS & ANSWERS

Q1.Can I buy an extra LED strip light to extend the equipment?

A1. No. The adapter can't provide the extra power. If you do it, it may cause overload the power supply.

Q2. Why does the strip can not light on after connection?

A2.Uninstall all the units and follow installation step to reinstall, plug out the plastic pad from the remote, click the On/Off button to turn on the lights. Please email us for any issue, we offer 24 mouths warranty.

CONTACT US

DAYBETTER GROUP LIMITED

Website: <http://www.daybetter.com>

Email: service@daybetter.com

WhatsApp: +86 19128309181

Please contact us if you have any problem or get a defective product. We will reply within 24 hours.